



Wetrooms & Insulation



Product catalogue

About us

Thermopanel Products

Established in 2003, Thermopanel is a member of the Pedarson Group, committed to creating high quality wet room components at an attractive price. We produce a wide range of wet room products, including: tile backer insulation boards, waterproofing, walkin shower trays, drains, shower screens, underfloor heating and wet room accessories.

At Thermopanel we love a good-looking wet room and the brand was created from a desire to ensure that the growing trend for wet rooms is accessible to everyone. However, at Thermopanel we believe that it is what's underneath that truly counts. We encourage people to look beyond the facade and appreciate the importance of quality wet room foundations - because if it's not properly waterproofed then it's a damp room, not a wet room!

The benefits of installing a Thermopanel Wet Room Include....



100% WATERTIGHT

The Thermopanel system provides a solid waterproof foundation which will eliminate leaks and water damage.



A COMPLETE WET ROOM SOLUTION

Thermopanel produces all of the supplies and products needed to install a highly functional wet room.



CAN INCREASE PROPERTY VALUE

Studies have shown that homes that add a wet room as a second bathroom are of a higher value than comparable homes with only a traditional bathroom.



DIFFERENTIATION

Make your development stand out from competitors. Complete the look of the home and add prestige with a wet room installation.



QUALITY & VALUE

Thermopanel produces high quality products created with the user in mind.

Contents

4	Tile Backer Board	24	Pipe Boxing
8	Square Drain Shower Trays	25	Shower Niches
16	Linear Drain Shower Trays	26	Bath Panels / Curved Boards
22	Shower Tray for Vinyl Floor	27	Accessories / Waterproofing Equipment



Create the backbone of your wet room with Thermopanel Tile Backer Boards

Thermopanel Tile Backer Insulation Boards are lightweight and easy to handle whilst providing superior waterproofing to your wet area. Available in a variety of sizes, they are incredibly versatile.

Thermopanel Tile Backer boards are specifically designed for two primary purposes -



As a first class heat insulation for underfloor heating systems.



As a superior waterproof surface to fix wall or floor tiles.

- Tile backer boards are particularly suited to underfloor heating mats and under tile heating cable applications.
- Will accept even the heaviest wall tiles, unlike plasterboard. (correct installation method must be followed)
- Installation below underfloor heating systems on an existing un-insulated concrete or timber sub-floor will greatly reduce heat up time and running costs.
- Our Boards will reduce the warm up time of the heating and reduce your electricity bill.
- Excellent heat insulation with thermal conductivity value of 0.027 W/mK making them ideal for use as a thermal barrier with under floor heating
- Ideal for wetrooms
- Tilebacker boards are waterproof and dimensionally stable (unlike plywood)
- Excellent sound insulation: impact sound is greatly reduced

Tile Backer Board / Construction Board

Description

Code	Length / Width / Thickness
TP06	1250 x 600 x 6mm
TP10	1250 x 600 x 10mm
TP12	1250 x 600 x 12mm
TP20	1250 x 600 x 20mm
TP30	1250 x 600 x 30mm
TP40	1250 x 600 x 40mm
TP50	1250 x 600 x 50mm



Wood Floor

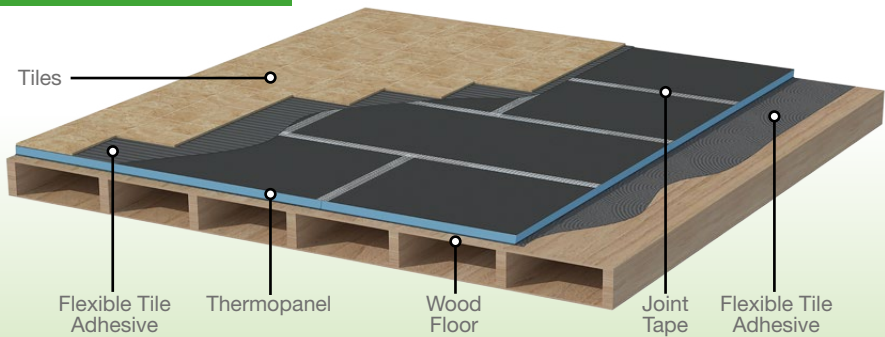

Concrete Floor

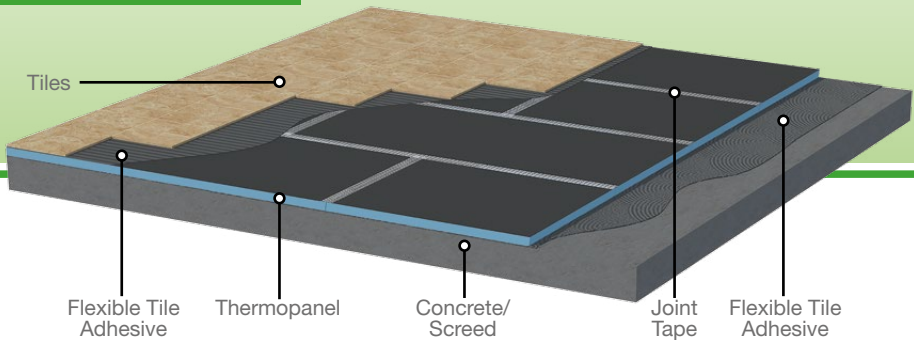

Installation Instructions For Tile Backer Boards

Timber Stud Walls

For walls made from stud, 10 or 12mm Thermopanel can be used for stud @ 300mm centres or 20mm Thermopanel if 600mm centres. Please ensure that all board edges are supported.

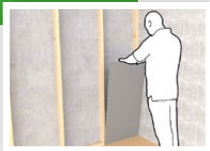

Fix Thermopanel to the studs using screws and Thermopanel washers (MSW36), the maximum spacing between fixings should be 300mm.



Solid Walls

Option 1 Screw Fixing

Measure the Thermopanel and cut to size utilizing a sharp knife or saw.

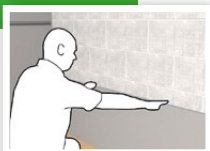

Wall plugs, screws and Thermopanel washers (MSW36) can be used at 300mm spacing to fix to a solid wall

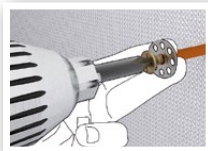

Solid Walls

Option 2 Tile Adhesive

A 5 to 8mm trowel is used to comb flexible tile adhesive over the whole surface of the Thermopanel.



Stagger the Thermopanel brickwork fashion, pushing them firmly onto wall.



Solid Walls

Option 3 Drywall Fixing

Apply Thermopanel Drywall Foam (TPDF) to Thermopanel, firstly around perimeter, then at (approx.) 300mm centres. Application to the board laid flat with its end against the wall is generally the quickest method for application to solid walls.

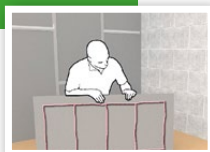

Allow the foam to cure for 4-5 minutes and then lever the board into position, then press firmly across the whole face of the board, starting at the top. Ensure the top and all edges receive as much pressure as the rest of the board.

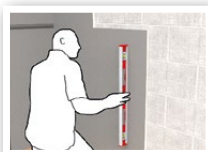

Preparation for Tiles or Plaster Tiling

All joints should be taped using Thermopanel Joint Scrim Tape (IJT90) with the exception of wet areas where Thermopanel butyl tape (Btape) should be used. The wall can now be tiled.



Plastering. Seal the edges of the boards using Thermopanel adhesive/sealant (Thermofix) before applying the Thermopanel scrim tape (IJT90). Plaster can now be applied.

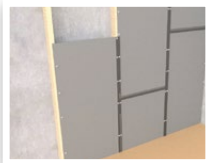

Floor Fixing Tile Adhesive

Use a 5-8mm trowel to apply a layer of flexible tile adhesive on to the base floor.

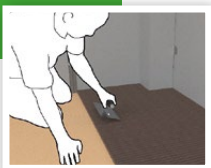

Place the Thermopanel down on the adhesive and push firmly down.



Floor Fixing Screws & Washers into Timber

Measure the Thermopanel and cut to size utilizing a sharp knife or saw. Lay Thermopanel in the desired position.



Use screws and Thermopanel washers (MSW36) to fix the boards every 300mm to the wooden subfloor.



If further waterproofing is required, use Thermopanel adhesive / sealant (Thermofix) to seal the joints. Alternatively, in really wet areas use Thermopanel Butyl Tape (Btape)

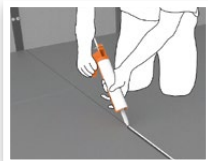

Square Drain Shower Tray Assembly Information



Shower tray kit consists of a shower tray and a drainage system. Both components are coordinated with each other and form one unit.

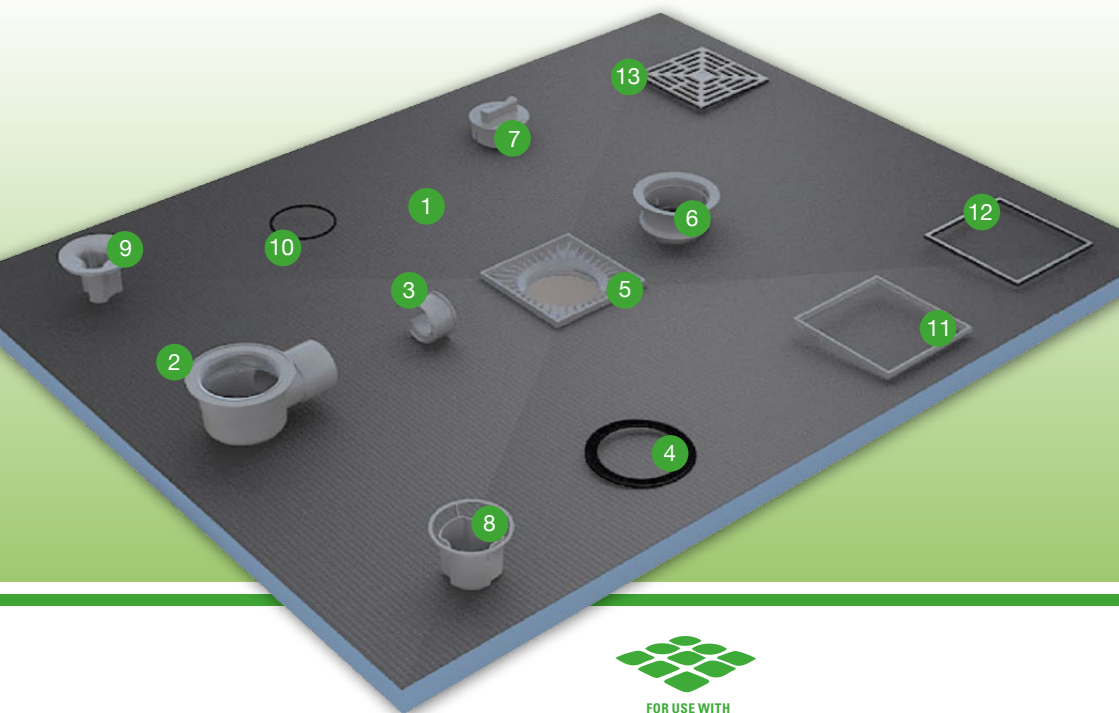

System components

- | | | |
|-------------------|-------------------|-------------------------|
| 1 Shower tray | 6 Connection | 11 Riser Piece |
| 2 Drain body | 7 Key | 12 Stainless Steel Edge |
| 3 50-40mm Reducer | 8 Drain Basket | 13 Grate |
| 4 Rubber O-Ring | 9 Inlet with seal | |
| 5 Plastic Support | 10 O-Ring | |

Specifications

Size	Central			Offset			Corner		
	Thickness (mm)								
	20	25	30	20	25	30	20	25	30
800 x 800									
900 x 900									
1000 x 1000									
1200 x 800									
1200 x 900									
1200 x 1000									
1200 x 1200									
1500 x 900									
1500 x 800									
1800 x 900									



NOTE:

Each side of the shower tray can be trimmed up to 50mm

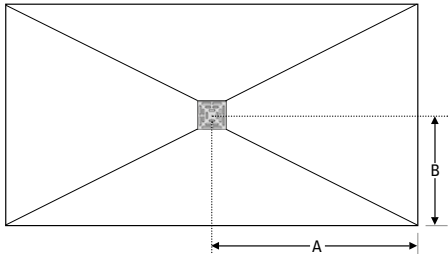

Position:Centre drain: A=1/2 length B=1/2 width

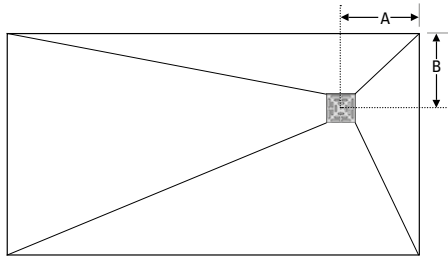

Normal Position:Corner drain: A=B=260mm

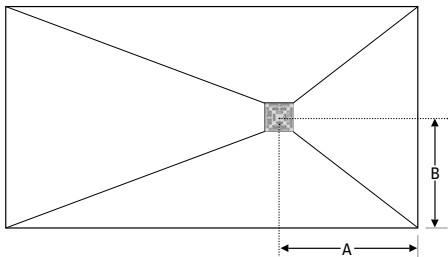

Normal Position:Offset drain: A=450mm B=1/2 width

Square Drain Shower Trays



Specifications

Part number	Description
SF0808CEN	800 x 800 x 20mm Square Shower Tray with Centre Drain
SF0808COR	800 x 800 x 20mm Square Shower Tray with Corner Drain
SF0909CEN	900 x 900 x 20mm Square Shower Tray with Centre Drain
SF0909COR	900 x 900 x 20mm Square Shower Tray with Corner Drain
SF1010CEN	1000 x 1000 x 20mm Square Shower Tray with Centre Drain
SF1010COR	1000 x 1000 x 20mm Square Shower Tray with Corner Drain
SF1010OFF	1000 x 1000 x 20mm Square Shower Tray with Offset Drain
SF1208CEN	1200 x 800 x 20mm Rectangular Shower Tray with Centre Drain
SF1208COR	1200 x 800 x 20mm Rectangular Shower Tray with Corner Drain
SF1208OFF	1200 x 800 x 20mm Rectangular Shower Tray with Offset Drain
SF1209CEN	1200 x 900 x 20mm Rectangular Shower Tray with Centre Drain
SF1209COR	1200 x 900 x 20mm Rectangular Shower Tray with Corner Drain
SF1209OFF	1200 x 900 x 20mm Rectangular Shower Tray with Offset Drain
SF1210CEN	1200 x 1000 x 20mm Rectangular Shower Tray with Centre Drain
SF1210COR	1200 x 1000 x 20mm Rectangular Shower Tray with Corner Drain
SF1210OFF	1200 x 1000 x 20mm Rectangular Shower Tray with Offset Drain
SF1212CEN	1200 x 1200 x 20mm Square Shower Tray with Centre Drain
SF1212COR	1200 x 1200 x 20mm Square Shower Tray with Corner Drain
SF1212OFF	1200 x 1200 x 20mm Square Shower Tray with Offset Drain
SF1508CEN	1500 x 800 x 25mm Rectangular Shower Tray with Centre Drain
SF1508OFF	1500 x 800 x 25mm Rectangular Shower Tray with Offset Drain
SF1509CEN	1500 x 900 x 25mm Rectangular Shower Tray with Centre Drain
SF1509OFF	1500 x 900 x 25mm Rectangular Shower Tray with Offset Drain
SF1809CEN	1800 x 900 x 25mm Rectangular Shower Tray with Centre Drain
SF1809OFF	1800 x 900 x 25mm Rectangular Shower Tray with Offset Drain
SFDRAIN	Square Drain

Installation Instructions For Square Drain Shower Tray

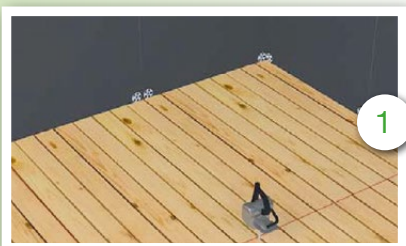

1 Put shower tray in the correct position and mark around the tray, to establish which section of the floor boards needs to be removed, the tray can be recessed.



2 Once the floorboards are removed, Measure and mark where your drain and waste pipe will be fitted.



3 Cut a piece of plywood to support the drain for drain body, this should be 10mm higher than waste pipe. Connect the drain body to the waste pipe with solvent weld in the usual way. (Always check for leaks before final installation of shower tray).



4 Fix a batten below the top of the joists.

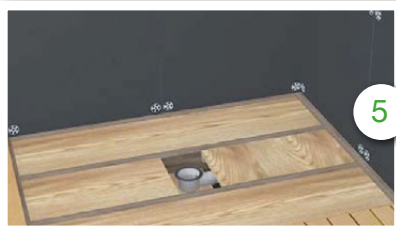

5

Once you are satisfied with the drainage, place plywood around the drain and fix in position.



6

Spread the adhesive evenly over the area where the shower tray is to be installed, being careful to clean away any adhesive on the rim of the trap.



7

Ensure that the surface is smooth & Level.

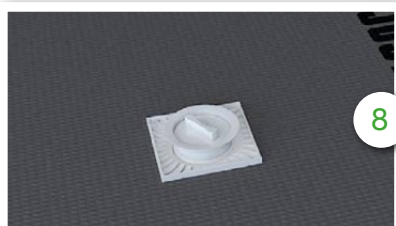

8

Fix the shower tray into position. With a spirit level, check that the edges of the tray are level. Also you should use waterproof tape to connect all joint and wall corners.



9

Seal all joints (both wall and floor) utilising special waterproof membrane / paste.



10

Seal all corners of shower area with inside corner membrane / paste.



11

Then set the O-ring on Inlet with Seal and put it in.



12

If there's height difference between tile and drain.

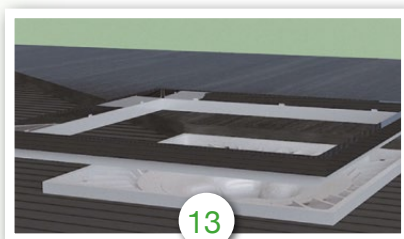

13

Use the riser piece to balance the height difference between tile and drain.

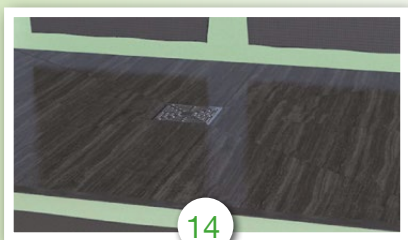

14

The shower base is finished and can be tiled.

Tips: In principle, you can use all types and sizes of tiles, special requirements for tiles and mosaic thickness to be <25mm, and the size of the tiles and mosaic on the shower tray must be =50 * 50mm. Otherwise, you should consult the manufacturer.

Installation Section Detail For Wooden Framework

Mokra Shower Tray Kit - Installation Height

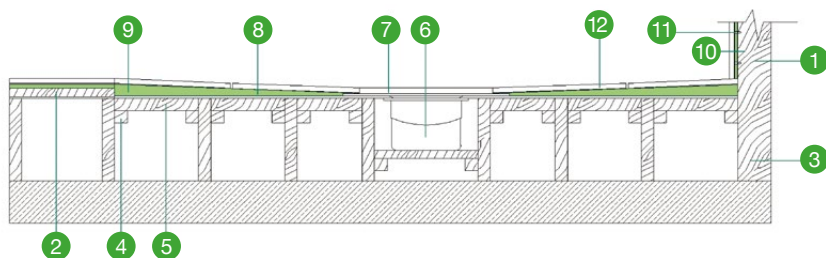

- | | | |
|----------------------------|--|-----------------------------|
| 1 Wooden wall construction | 7 Stainless steel grate | 10 Backer board (6/10/20mm) |
| 2 Floor board 18mm | 8 Shower tray | 11 Washer and screw |
| 3 Floor joist | 9 Sealing tape or Waterproofing membrane | 12 Tiles |
| 4 Support for ply board | | |
| 5 Ply board 18mm | | |
| 6 Shower drain body | | |

Installation Section Detail For Concrete Floor

Mokra Shower Tray Kit - Installation Height

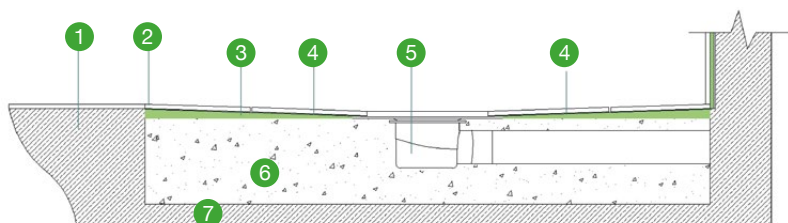

- | | | |
|---------------------------|---------------|--------------------|
| 1 Screed | 4 Slope | 6 Levelling screed |
| 2 Waterproof sealing tape | 5 Floor drain | 7 Concrete floor |
| 3 Shower tray | | |

Linear Drain Shower Tray Assembly Information



Linear shower tray kit consists of a shower tray and a drainage system. Both components are coordinated with each other and form one unit.



System components

- | | | | |
|----|--|-----|---|
| 1 | Drain Body | 7b | Short Or Long Screw
For Height Adjustment Spacer
(Please use these screws according
to your requirement) |
| 2 | Dip-tube | 8 | Connection |
| 3 | O Ring | 9 | Plastic support 600mm length |
| 4 | Drain Basket | 10a | Stainless Steel Support
600mm length. |
| 5 | 50-40mm Reducer | 10b | Stainless Steel Grate
600mm length |
| 6 | Height Adjustment
Spacer (thickness1.5mm) | | |
| 7a | Screw For Connection
(M5.5*29mm) | | |

Specifications

Part number	Description
SF0909LIN	900 x 900 x 30mm Square Shower Tray with Linear Drain
SF1209LIN	1200 x 900 x 30mm Rectangular Shower Tray with Linear Drain
SF1509LIN	1500 x 900 x 30mm Rectangular Shower Tray with Linear Drain
SF1809LIN	1800 x 900 x 30mm Rectangular Shower Tray with Linear Drain
SF1209LIN90	1200 x 900 x 30mm Rectangular Shower Tray with Linear Drain (side)
SF1509LIN90	1500 x 900 x 30mm Rectangular Shower Tray with Linear Drain (side)
SF1809LIN90	1800 x 900 x 30mm Rectangular Shower Tray with Linear Drain (side)
SFLG01	Linear Shower Grate - Slots
SFLG05	Linear Shower Grate - Wavy
SFLG08	Linear Shower Grate - Crest
SFLG12	Linear Shower Grate - Droplets
SFLG15	Linear Shower Grate - Greek
SFLG16	Linear Shower Grate - Stars
SFLT01	Linear Shower Grate - Tile
SFLT02	Linear Shower Grate - Solid
SFLD	Linear Shower Drain

Available sizes

Part no	Dimensions					
	X	Y	A	B	C	D
SF0909LIN	900	900	600	150	200	70
SF1209LIN	1200	900	600	150	200	70
SF1509LIN	1500	900	600	150	200	70
SF1809LIN	1800	900	600	150	200	70

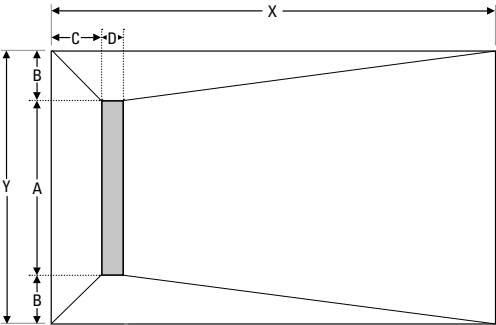

Part no	Dimensions					
	X	Y	A	B	C	D
SF1209LIN	1200	900	600	300	200	70
SF1509LIN	1500	900	600	450	200	70
SF1809LIN	1800	900	600	600	200	70

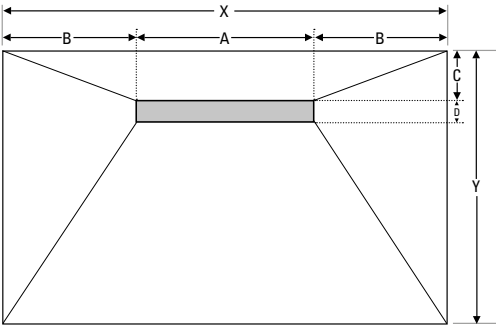

Installation Instructions For Linear Shower Tray



1 Put shower tray in the correct position and mark around the tray, to establish which section of the floor boards need to be removed, the tray can be recessed.

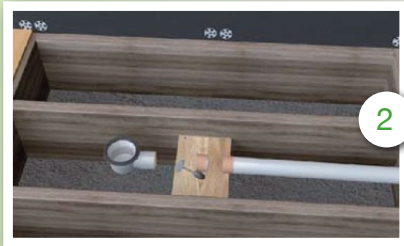

2 Once the floorboards are removed, Measure and mark where your drain and waste pipe will be fitted.



3 Cut a piece of plywood to support the drain for drain body, this should be 10mm higher than waste pipe. Connect the drain body to the waste pipe with solvent weld in the usual way. (Always check for leaks before final installation of shower tray).



4 Fix a batten below the top of the joists.

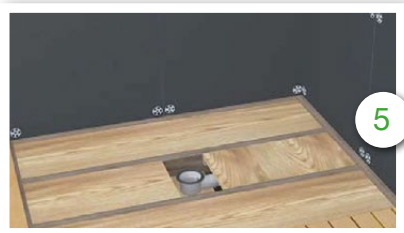

5

Once you are satisfied with the drainage, place plywood around the drain and fix in position.



6

Spread the adhesive evenly over the area where the shower tray is to be installed, being careful to clean away any adhesive on the rim of the trap.



7

Ensure that the surface is smooth & Level.



8

Seal all joints (both wall and floor) utilising special waterproof membrane / paste.

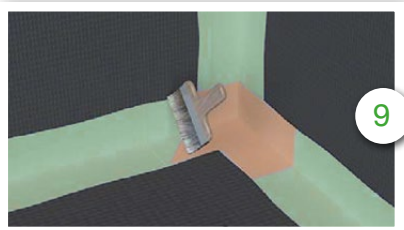

9

Seal all corners of shower area with inside corner membrane / paste.



10

Assemble other drain components



11a

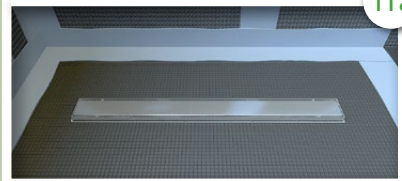

If you're not using a tile on grate, adjust the height of the stainless steel support utilising the height adjustment spacers, each space will increase the height by 1.5mm. Depending on the number of spacers used, use either the long or short screws to fix the stainless steel support to the tray



11b



If you're using a tile on grate, the height of the stainless steel support can be adjusted utilising the height adjustment spacers, but the inner height of the tile on the grate is fixed (13mm). Please ensure that you use suitable tiles for the grate and the shower tray.



12

The shower base is now finished and can be tiled.

Installation Section Detail For Wooden Floor

Mokra Linear Shower Tray

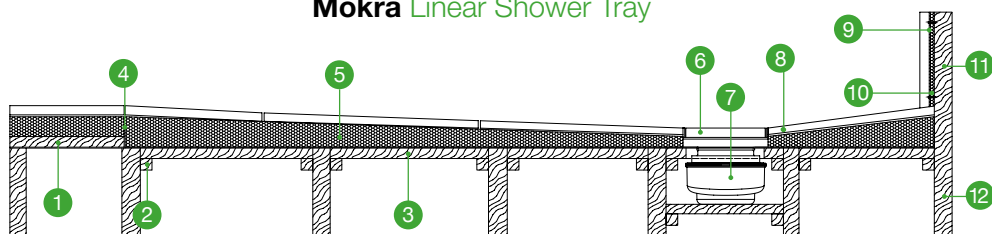

- | | | |
|-------------------------|------------------------------|-----------------------------|
| 1 Floor board 18mm | 6 Stainless steel grate | 11 Wooden wall construction |
| 2 Support for PLY board | 7 Linear Shower drain body | 12 Floor joist |
| 3 PLY board 18mm | 8 Tile | |
| 4 Waterproof paint | 9 Washer and screw | |
| 5 Linear shower tray | 10 backer board (10/12/20mm) | |

Installation Section Detail For Concrete Floor

Mokra Linear Shower Tray

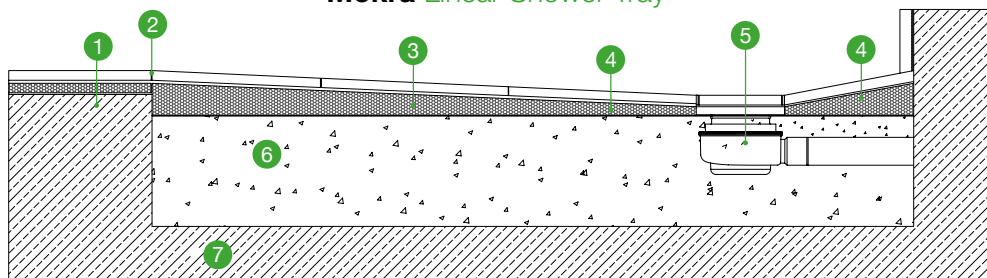

- | | |
|--------------------|----------------------------|
| 1 Screed | 5 Linear Shower drain body |
| 2 Waterproof paint | 6 Levelling screed |
| 3 Shower tray | 7 Concrete floor |
| 4 Slope | |

Voda

Voda is affordable, strong and available in a wide range of size options.

Voda is highly adaptable and means that every home can enjoy the superior style and luxury that a wet room provides.

Constructed from solid glass reinforced plastic, it is strong enough to fit straight onto joists, saving time and money.

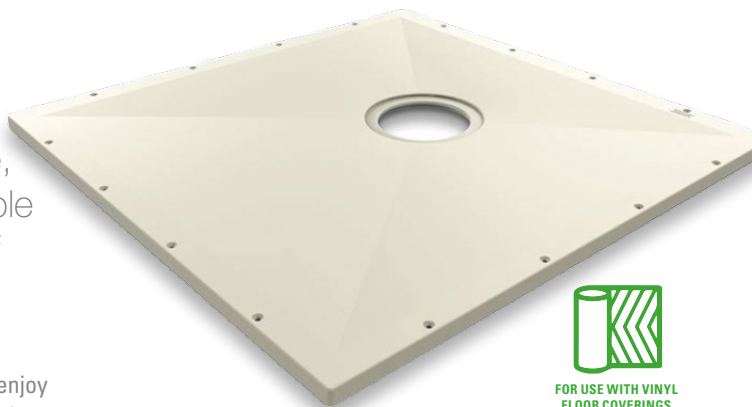

FOR USE WITH VINYL FLOOR COVERINGS

Features

- Made from extra tough Glass Reinforced Plastic (GRP)
- Super strong single piece construction
- Fixes straight onto joists saving time and money
- 20-year guarantee for peace of mind

Available sizes

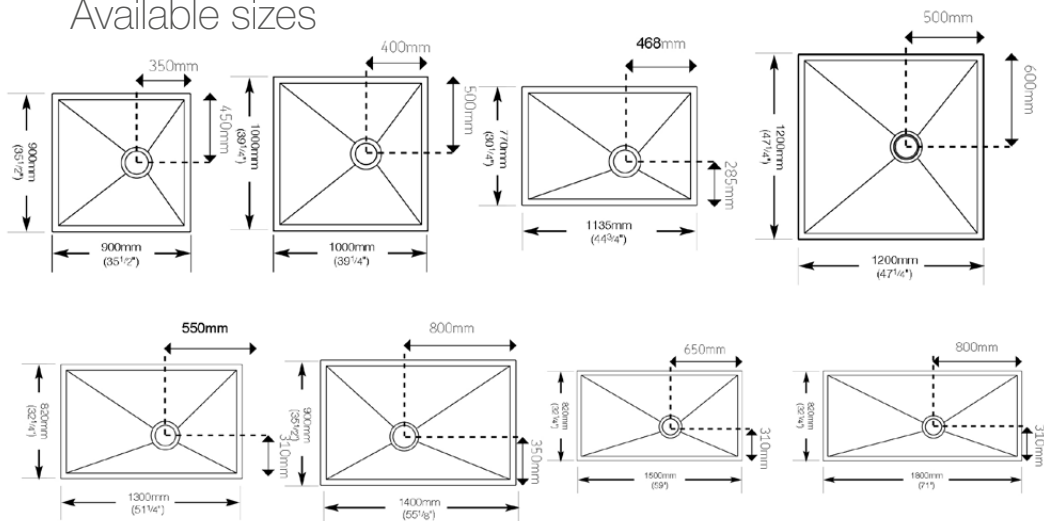

Voda

Features

- GRP composition
- Trimmable for extra versatility
- 20-year guarantee
- Load capacity of up to 25 stone/158kg
- Suitable for wooden and solid floors
- 8 sizes c/w waste
- Fixes onto joists – no underboarding

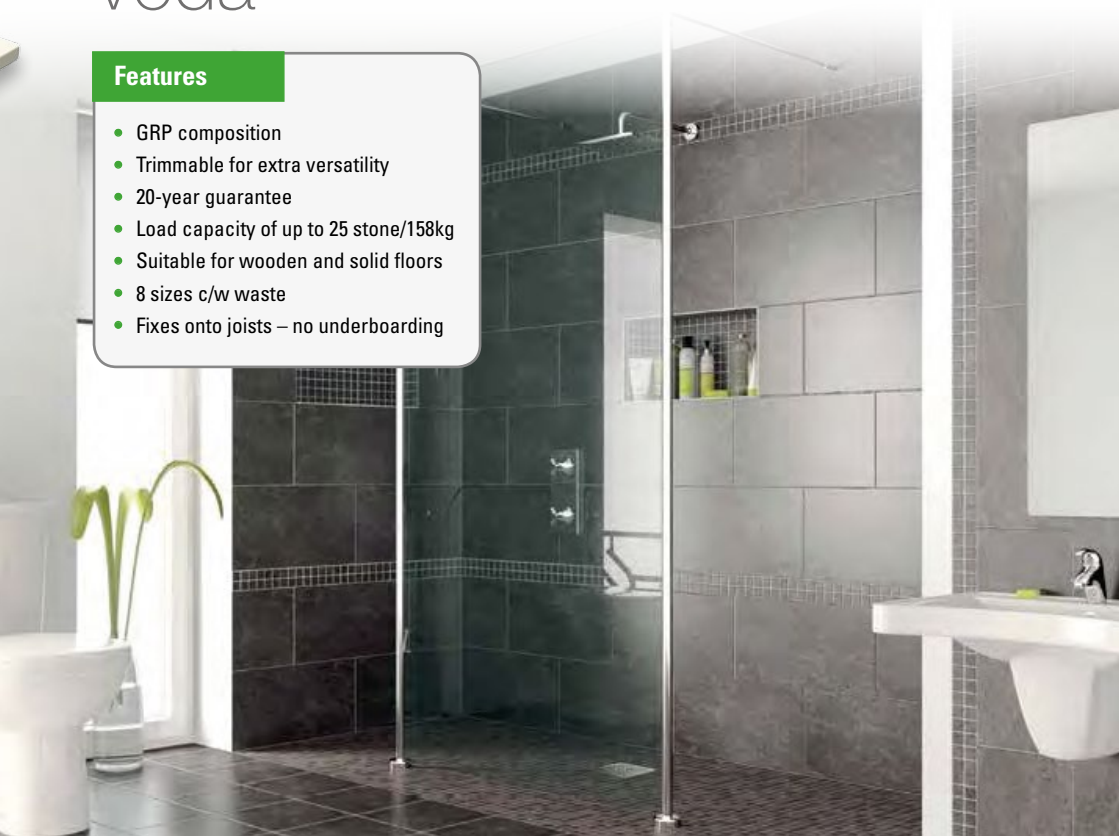

Part Number	Description	Width (mm)	Length (mm)
SF0909V	Voda Panel 900 x 900 (Waste included)	900	900
SF1010V	Voda Panel 1000 x 1000 (Waste included)	1000	1000
SF1111V	Voda Panel 1135 x 1135 (Waste included)	1135	1135
SF1212V	Voda Panel 1200 x 1200 (Waste included)	1200	1200
SF1382V	Voda Panel 1300 x 820 (Waste included)	1300	820
SF1409V	Voda Panel 1400 x 900 (Waste included)	1400	900
SF1582V	Voda Panel 1500 x 820 (Waste included)	1500	820
SF1882V	Voda Panel 1800 x 820 (Waste included)	1800	820

Thermopanel Pipe Boxing

The Solution to Hide Unsightly Pipework

Specially designed to enable easy, fast and clean boxing-in of exposed pipe work. The Thermopanel pipe Boxings are completely waterproof so they are suitable for shower and wet rooms, as well as bath.

The Pre-fabricated boards are 20 mm thick. Made from 100% HCFC-FREE XPS hard foam, reinforced with fiberglass mesh on both sides and coated with polymer-modified mortar. The boards are 100% waterproof and remain fully functional.

Thermopanel shaped Angle Board can simply cover the water pipes and other attachment by flexible tile adhesive. Its cemented surface is a good adhesive undersurface for tiling. The easy installation can save a lot of time and money.

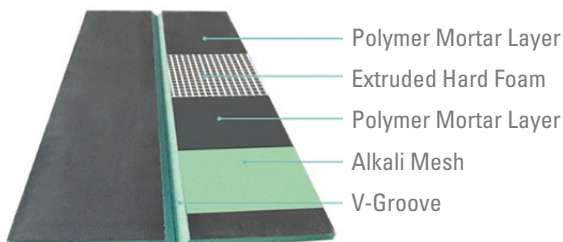

Features

- Can be either tiled or plastered
- Fast and efficient way to box in pipes prior to tiling or plastering
- Greatly reduces installation time
- Provides a much better tiling surface than timber
- Reduces the need to plasterboard timber when applying render
- Waterproof and stable in a moist environment
- Can be used to create designs in a bathroom rather than simply covering unsightly features
- Easy and cost effective method for creating tiled columns and rounded corners panels.

Part Number	Description	Thickness (mm)	Width (mm)	Height (mm)	Depth (mm)
TP150	Pipe Boxing Panel – 'L'	20	150	150	1250
TP200	Pipe Boxing Panel – 'L'	20	200	200	1250
TP300	Pipe Boxing Panel – 'L'	20	300	300	1250

Thermopanel Shower Niches

Thermopanel Shower Niches are low cost, easily installed and completely waterproof. Designed to provide extra space for small shower items.

They comprise of an extruded polystyrene core coated on either side with a thin robust layer of fibreglass reinforced polymer concrete and coated with a waterproof membrane paint.

Thermopanel Shower Niches are fixed to a timber frame, so that the front of the Niche are flush with the Thermopanel construction boards on the wall. The joints between the Niche and the construction boards are sealed together with Waterproof Tape.

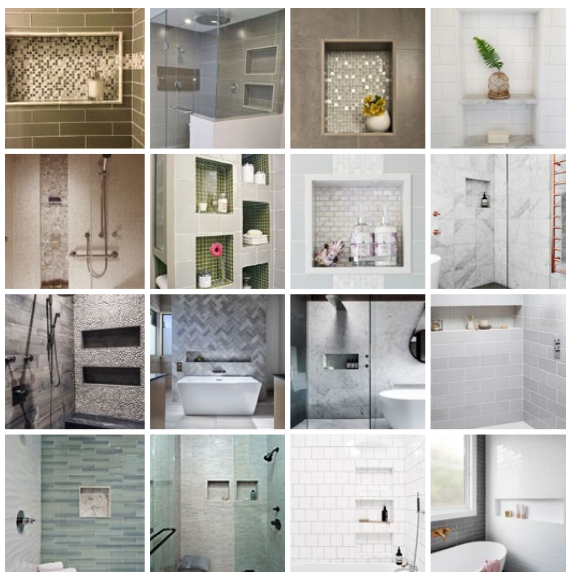

Features

- Completely waterproof.
- Provides thermal insulation.
- Ready to tile.
- Lightweight and easy to work with.
- Made with 12.5mm thick board and fit wall cavities 100mm or deeper
- Comes already constructed which guarantees the conformity and the size

Part Number	Description	Width (mm)	Height (mm)	Depth (mm)
TPN350240	Tileable Shower Niche	350	240	100
TPN350350	Tileable Shower Niche	350	350	100
TPN350420	Tileable Shower Niche	350	420	100
TPN900540	Tileable Shower Niche	900	240	100

Bath Panels

Perfect for tiling around your bath with tiles matching the walls and/or floor, Thermopanel bath panels offer the best solution.

The panels just need to be cut to the correct length, positioned and height adjusted using the integral feet. You're now ready to tile!



Part Number	Description	Length (mm)	Width (mm)	Depth (mm)
TPBP1	Tileable Side Bath Panel with 2 adjustable Feet	2100	600	30
TPBP2	Tileable End Bath Panel with 1 adjustable Foot	770	600	30

Thermopanel Curved Boards

Thermopanel Pre-Slit Curved Boards are the perfect solution for the fast creation of curved walls, curved bathroom panels, moulded tiled seats and P-shaped baths.

The boards are exceptionally easy to work with, easy to cut and shape with excellent tile adhesion and waterproofing properties.

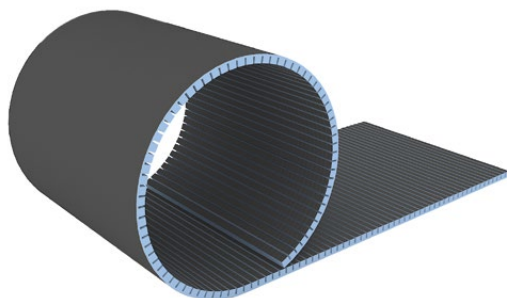

Part Number	Description	Length (mm)	Width (mm)	Depth (mm)
TP20CB	Curved Construction board	1250	600	20

Accessories

Part number	Description
WP-TAPE-5	5m Waterproof Membrane Tape
WP-COR-INT	Waterproof Membrane Internal Corner
WP-COR-EXT	Waterproof Membrane External Corner
WP-LINER-5	Waterproof Membrane Shower Liner - 5m
WP-LINER-30	Waterproof Membrane Shower Liner - 30m
BTAPE	Butyl Waterproofing Tape (100mm x 5m)
WODER-W-4.5	Atlas Woder Waterproofing / Tanking Membrane - 4.5Kg
PRIMER	Primer 1L
SMS30	Atlas Self Levelling Compound - 25Kg
PLUS-EXPRESS	Atlas Plus Express Flexible Tile Adhesive - 25Kg
THERMOFIX	Solvent Free Adhesive & Sealant



WP-TAPE-5

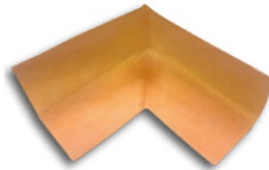

WP-COR-INT



WP-COR-EXT



WP-LINER-5
WP-LINER-30



BTAPE



WODER-W-4.5



PRIMER



PLUS-EXPRESS
SMS30



THERMOFIX

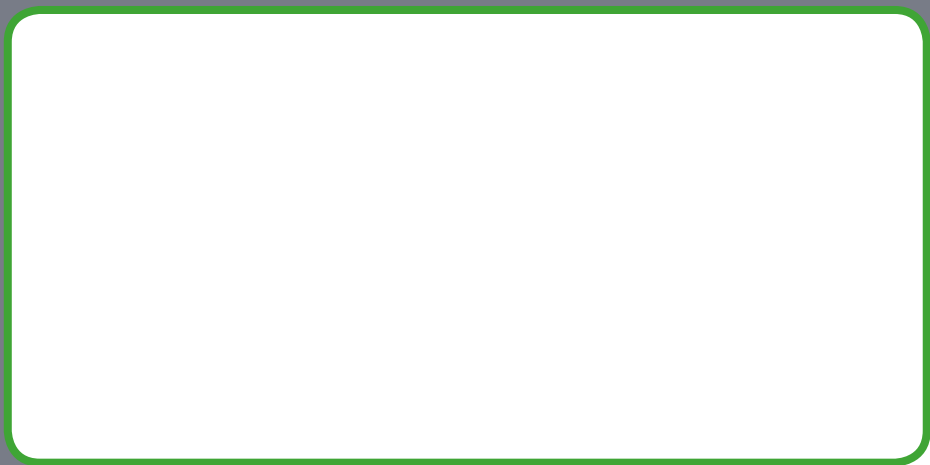

www.thermopanel.co.uk ■ mail@thermopanel.co.uk ■ t: 01394 593 110

Unit 16, Martlesham Creek Ind Est, Sandy Lane,
Woodbridge, Suffolk. IP12 4SD